

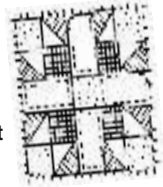

# JUNIOR SHOW DEPT. P-4 TEXTILES



**SHARON BETTENHAUSEN, (Mrs. Dale), Superintendent**  
**JOAN MEIER, Asst. Superintendents**

**Entries Open Friday, July 27, 2018**

**Entries Close Monday, August 6, 2018 - 5:00 p.m.**

**Estimated Amount Offered \$1,110.00**

Entry Fee - \$1.00 per entry

Judging Time - 9:30 a.m., Wednesday, August 22

### DO NOT BRING EXHIBIT AT TIME OF REGISTERING ENTRY

Entries can be brought in the Main Exhibit building Tues., Aug. 21 from 3:00 p.m. to 8:00 p.m. Wed., Aug. 22 from 7:00 a.m. to 8:30 a.m. Sharp! - Building closes at 9:00 a.m. for judging. **Sun., Aug. 26th the Fine Arts building will close at 7:00 p.m. The building will then re-open once the entries are prepared for pickup, and will remain open until 9:00 p.m. Fine Arts exhibitors will enter/exit through the North gate on Sunday to pick up exhibits.**

Each exhibitor shall be limited to one entry per class number.

**ENTRIES WHICH HAVE WON 1ST PREMIUMS IN THIS DEPARTMENT OF PREVIOUS WILL COUNTY FAIRS ARE NOT ELIGIBLE TO COMPETE.**

Entries must be the work of the exhibitor and entered in the name of the one making same, and must be in acceptable condition. Work done in the past two years will be eligible if in good condition and not soiled.

Entry tag must be fastened on right shoulder seam of garment.

**Entries open to young people who were between 13-18 years of age by September 1st of the year previous to the fair (2017).**

Class No.		1st	2nd	3rd
3260	Pajamas .....	6.00	5.00	4.00
3261	Pajama Pants .....	6.00	5.00	4.00
3262	Robe .....	6.00	5.00	4.00
3263	Blouse .....	6.00	5.00	4.00
3264	Knit Top .....	6.00	5.00	4.00
3265	Apron, Any Kind .....	6.00	5.00	4.00
3266	Sport Clothes .....	6.00	5.00	4.00
3267	Coat .....	6.00	5.00	4.00
3268	Dress, w/Jacket .....	6.00	5.00	4.00
3269	Dress, Cotton or Cotton Blend .....	6.00	5.00	4.00
3270	Dress, Synthetic Fiber .....	6.00	5.00	4.00
3271	Sun Dress, Cotton or Cotton Blend .....	6.00	5.00	4.00
3272	Dress, Formal .....	6.00	5.00	4.00
3273	Jumper .....	6.00	5.00	4.00
3274	Suit .....	6.00	5.00	4.00
3275	Skirt .....	6.00	5.00	4.00
3276	Culottes or Skort .....	6.00	5.00	4.00
3277	Slacks .....	6.00	5.00	4.00
3278	Vest .....	6.00	5.00	4.00
3279	Jacket, Lined .....	6.00	5.00	4.00
3280	Jacket, Unlined .....	6.00	5.00	4.00
3281	Any Denim Garment .....	6.00	5.00	4.00
3282	Towel, embroidered .....	6.00	5.00	4.00
3283	Towel, Cross-stitch .....	6.00	5.00	4.00
3284	Lunch Cloth and 4 Napkins .....	6.00	5.00	4.00
3285	Pillow, Any Kind .....	6.00	5.00	4.00
3286	Pot Holders, (2) Any Kind .....	6.00	5.00	4.00
3287	Quilt, Any Kind .....	6.00	5.00	4.00
3288	Wall Hanging, Fabric - any .....	6.00	5.00	4.00
3289	Fleece Hand Tied Blanket .....	6.00	5.00	4.00
3290	Best of Show (no entry number required) .....	\$5.00 & Rosette		
3291	Buy Your Own Dress, include a picture wearing dress .....	6.00	5.00	4.00
3292	Buy Your Own Jacket, include a picture wearing jacket .....	6.00	5.00	4.00
3293	Buy Your Own Slacks, include a picture wearing slacks .....	6.00	5.00	4.00
3294	Best of Show .....	\$5.00 & Rosette		